



Western Gateway

Royal Victoria Dock, London, E16 1BL

Asking Price £325,000



MADISON BROOK
INTERNATIONAL

Western Gateway, Royal Victoria Dock, London, E16 1BL

This wonderful one-bedroom apartment is situated on the ground floor of The Oxygen Apartments and benefits from open-plan living with a sizable terrace, good-sized bedroom, well proportioned built-in storage cupboards and underfloor heating.

This property has been very well cared for & offers modern living with a private terrace with space to dine. Both bathroom & kitchen are finished to a modern standard with quality fittings being used throughout. Additionally, the property offers a concierge service and is well maintained throughout.

Conveniently situated near to local amenities and transport in the Royal Docks. Nearby to the cable cars and water sports centre. The shops, bars and restaurants in Canary Wharf are easily reached by transport.



These particulars, whilst believed to be accurate are set out as a general outline only for guidance and do not constitute any part of an offer or contract. Intending purchasers should not rely on them as statements of representation of fact, but must satisfy themselves by inspection or otherwise as to their accuracy. No person in this firms employment has the authority to make or give any representation or warranty in respect of the property.

20 Western Gateway, Royal Victoria Dock, London, E16 1BS
Tel: 020 3946 6000 Email: docklands@madisonbrook.com <https://madisonbrook.com/>

Floor Plan

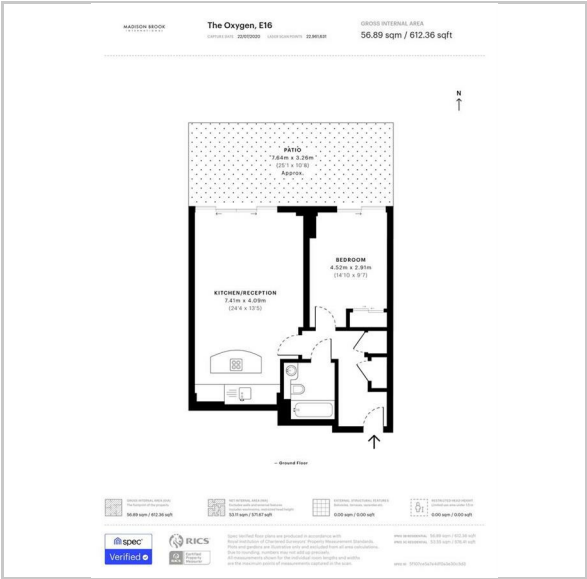

Area Map

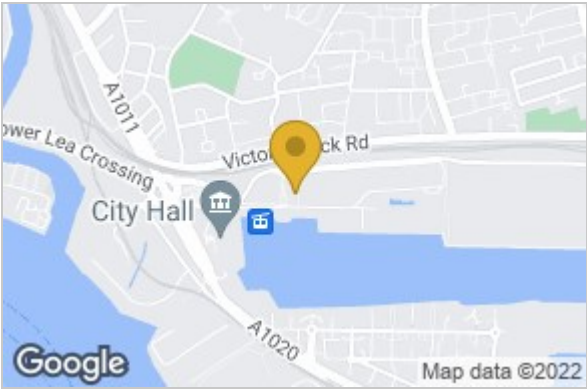

Energy Efficiency Graph

